



## MLT-601-12-60-T5



- ✓ Load for 12VDC LED or Halogen Lamp
- ✓ Compact size
- ✓ Low profile
- ✓ Class 2 compliance
- ✓ 5 Year Warranty
- ✓ No Min. Load
- ✓ FCC Class B Compliant
- ✓ ELV Dimmable

### ■ Mechanical

\*Dimension in metrics/inch

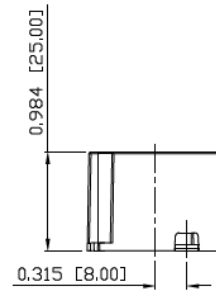
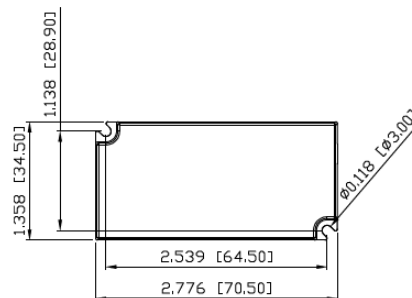

### ■ Electrical

Maximum load	60 W
Input Voltage	120VAC
Output Voltage	12VDC
Output Current	5A
Efficiency	>80%
No Load loss	< 1 W
Max. Tc Temperature	80°C

### ■ Wiring Diagram

